

10 Laurel Gardens  
Ashford TW15 1HS  
£235,000



## 10 Laurel Gardens, Ashford, TW15 1HS

Laurel Gardens, Ashford is a popular residential location offering easy access to the areas local amenities and transport links. This one bedroom apartment is situated on the ground floor of this modern development and is sold with no onward chain. The property comprises; double bedroom with built in wardrobes, modern bathroom, separate kitchen and large lounge with access onto the private garden. Other notable features include gas central heating and double glazing. Offered to the market with no onward chain this property is a must see. Viewings are encouraged and can be booked by calling Aspen Residential.



Floor Plan

Area Map

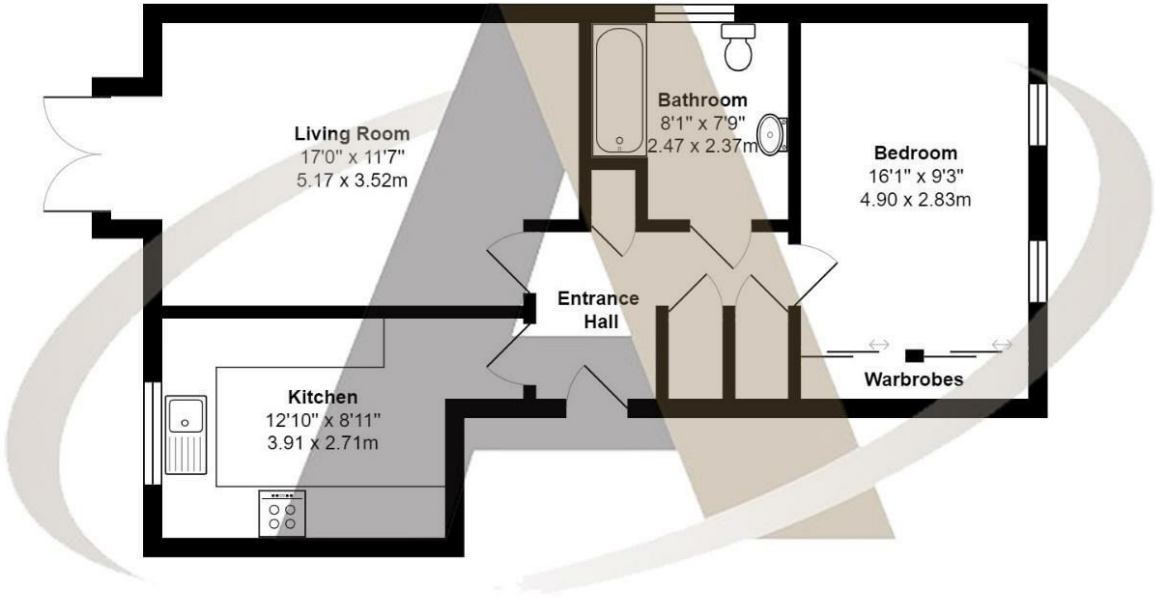

Laurel Gardens, Ashford

Total Area: 619 ft² ... 57.5 m²

All measurements are approximate and for display purposes only

Features

- Allocated Parking
- No Onward Chain
- Modern Development
- Parking Available
- Ground Floor
- Private Garden
- 1 Bedroom Apartment
- Doors onto Gardens



